

**OXNARD SCHOOL DISTRICT  
SURVEY OF SCHOOL SITES AND BUILDING SIZE**

SCHOOL SITE: TRANS/WHSE  
ACREAGE: 1.7

DATE: 09-26-08

<b>BUILDING NO.</b>	<b>SQUARE FT.</b>	<b>CONST.DATE</b>	<b>PERMANENT</b>	<b>PORTABLE</b>	<b>REMARKS</b>
1	21130 21130	1988	X		WAREHOUSE, OFFICES, MECHANICS SHOPS



**LEGEND:**



ELECTRICAL PANEL (MAIN) [RED]



WATER HEATER [BLUE]

(ABOVE @ MEZZANINE AREA)



DOMESTIC WATER SHUT-OFF VALVE [BLUE]

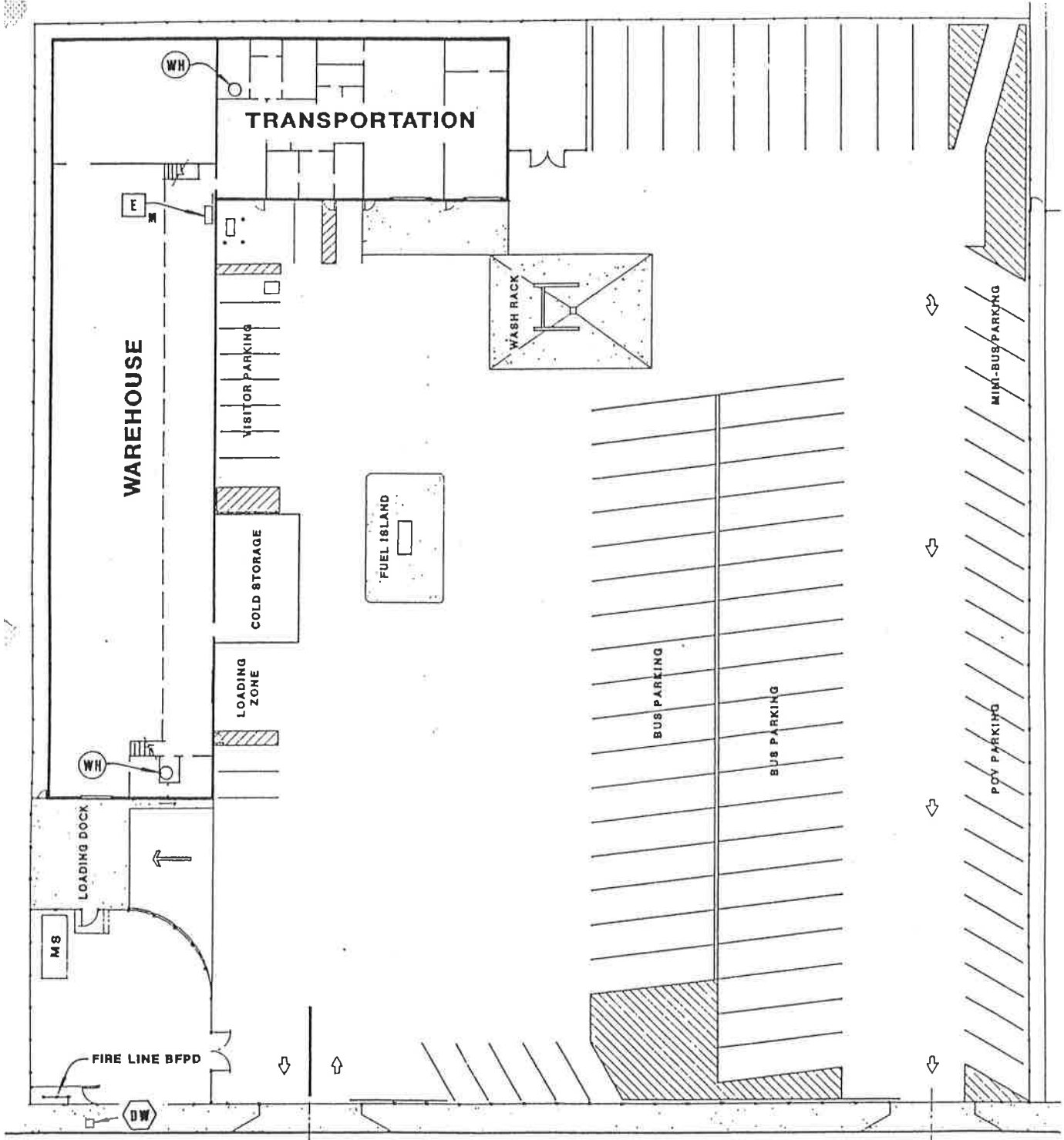

INSTRUCTION DATE = 1988  
 PERMITS REQUIRED = 1.7 AC  
 BUILDING DESIGN AREA = 21,130 SF

**SITE PLAN**



WOOLEY ROAD

RCH 1994 DATE SHOWN DRAWN BY: JA	<b>OXNARD SCHOOL DISTRICT</b> 1051 SOUTH A STREET OXNARD, CALIFORNIA	<b>PLAN</b> WAREHOUSE/TRANSPORTATION	DRAWING No. <b>P 120</b> SHEET <u>1</u> of <u>1</u>
--	--	---	---