

**OXNARD SCHOOL DISTRICT  
SURVEY OF SCHOOL SITES AND BUILDING SIZE**

SCHOOL SITE: SIERRA LINDA  
ACREAGE: 11.13

DATE: 9-26-08

BUILDING NO.	SQUARE FT.	CONST.DATE	PERMANENT	PORTABLE	REMARKS
1	5875	1966	X		ADMIN./MULTIPURPOSE
2	3185	1967	X		CLASSROOMS(KDGN.)
3	6364	1966	X		CLASSROOMS
4	6364	1966	X		CLASSROOMS
5	6364	1966	X		CLASSROOMS
6	809	1966	X		RR
7	809	1966	X		RR
801	1920	2000		X	LIBRARY
802	960	2000		X	WORKROOM
901-904	2907	1968		X	CLASSROOMS
905	960	1960		X	CLASSROOMS
906	960	1997		X	RSP
907	960			X	SPCH/INTERVENTION
1001	960	1997		X	CLASSROOM
1002	960	1997		X	CLASSROOM
1003	960	1997		X	CLASSROOM
1004	960	1998		X	CLASSROOM
1005	960	1998		X	CLASSROOM
1006	960	1998		X	CLASSROOM
1007	960	1999		X	CLASSROOM
11	960	1960		X	CLASSROOM
	<b>46117</b>				

**OXNARD SCHOOL DISTRICT  
SURVEY OF SCHOOL SITES AND BUILDING SIZE**

SCHOOL SITE: SIERRA LINDA SCHOOL  
 ACREAGE: 11.13  
 SQ. FT. OF BLDGS.: 44,197

DATE PREPARED: 9-28-00

REVISED 11-06-01

BUILDING NO.	SQ. FOOTAGE	CONST. DATE	TYPE OF CONSTRUCTION		REMARKS
			PERMANENT	PORTABLE	
1	5875	1966	X		ADMIN./MULTIPURPOSE
2	3185	1967	X		CLASSROOMS (KDN.)
3	6364	1966	X		CLASSROOMS
4	6364	1966	X		CLASSROOMS
5	6364	1966	X		CLASSROOMS
6	809	1966	X		R/R
7	809	1966	X		R/R
8	1920	2000		X	LIBRARY
	960	2000		X	WORKROOM
9	2907	1968		X	CLASSROOMS
	960	1960		X	CLASSROOM
	960	1997		X	CLASSROOM
10	960	1997		X	CLASSROOM
	960	1997		X	CLASSROOM
	960	1997		X	CLASSROOM
	960	1998		X	CLASSROOM
	960	1998		X	CLASSROOM
	960	1998		X	CLASSROOM
	960	1999		X	CLASSROOM
	960	1960		X	CLASSROOM
11	960	1960		X	CLASSROOM

# SIERRA LINDA SCHOOL

REVISED 10-01-01

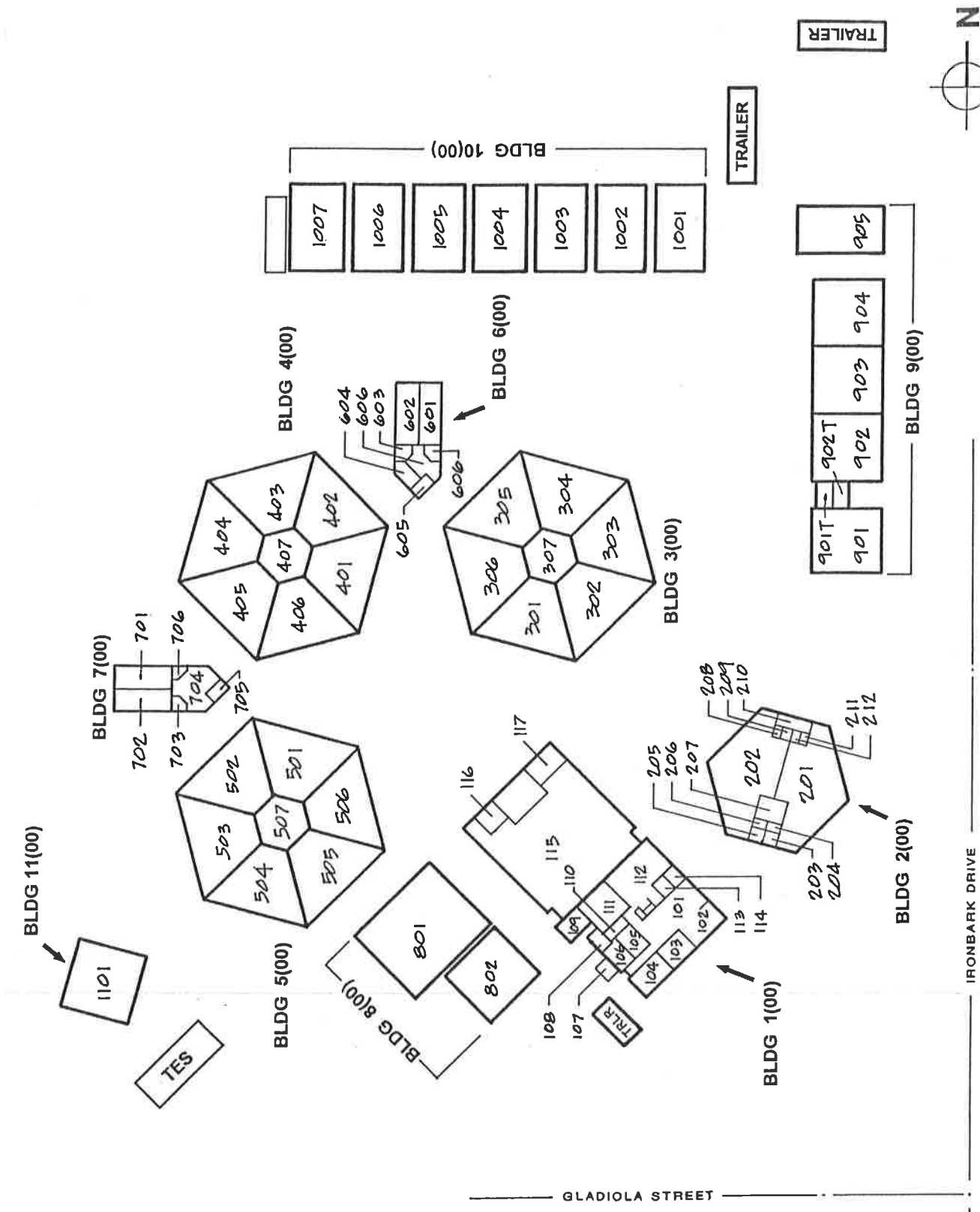

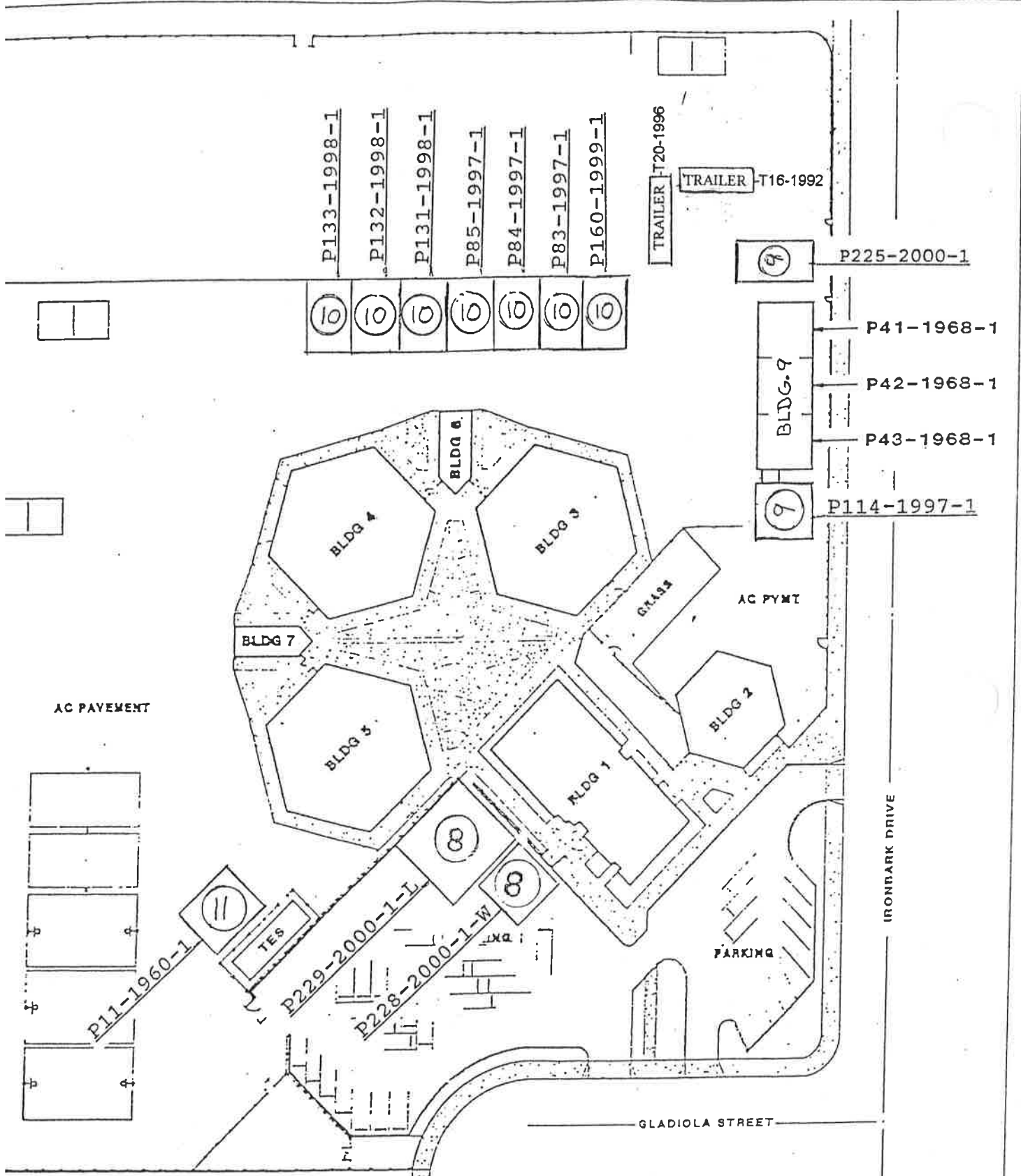

CONSTRUCTION DATE = 1966  
 SITE AGE = 11.13 AC  
 TOTAL BUILDING SQ. FOOTAGE:  
 PERMANENT BLDGS = 29,770 SF  
 PORTABLE BLDGS = 14,427 SF

SITE PLAN  
 NO SCALE

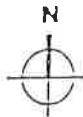

REVISED 11-06

1 MAY 93 DRAWN	OXNARD SCHOOL DISTRICT 1051 SOUTH A STREET OXNARD, CALIFORNIA	PLAN SIERRA LINDA SCHOOL	DRAWING No. P 117 SHEET 1 of 1
-------------------	---	-----------------------------	--------------------------------------

Project: Sierra Linda Elementary School  
 Oxnard Elementary School District  
 Address: Izetta Street and Jasmine Street  
 Oxnard, California

Existing (1-A) ✓  
 Basic Plans (2-A)  
 Final Plans (3-A)

Total acreage: 12.0

799.92'

HOLLY AVE (FUTURE)

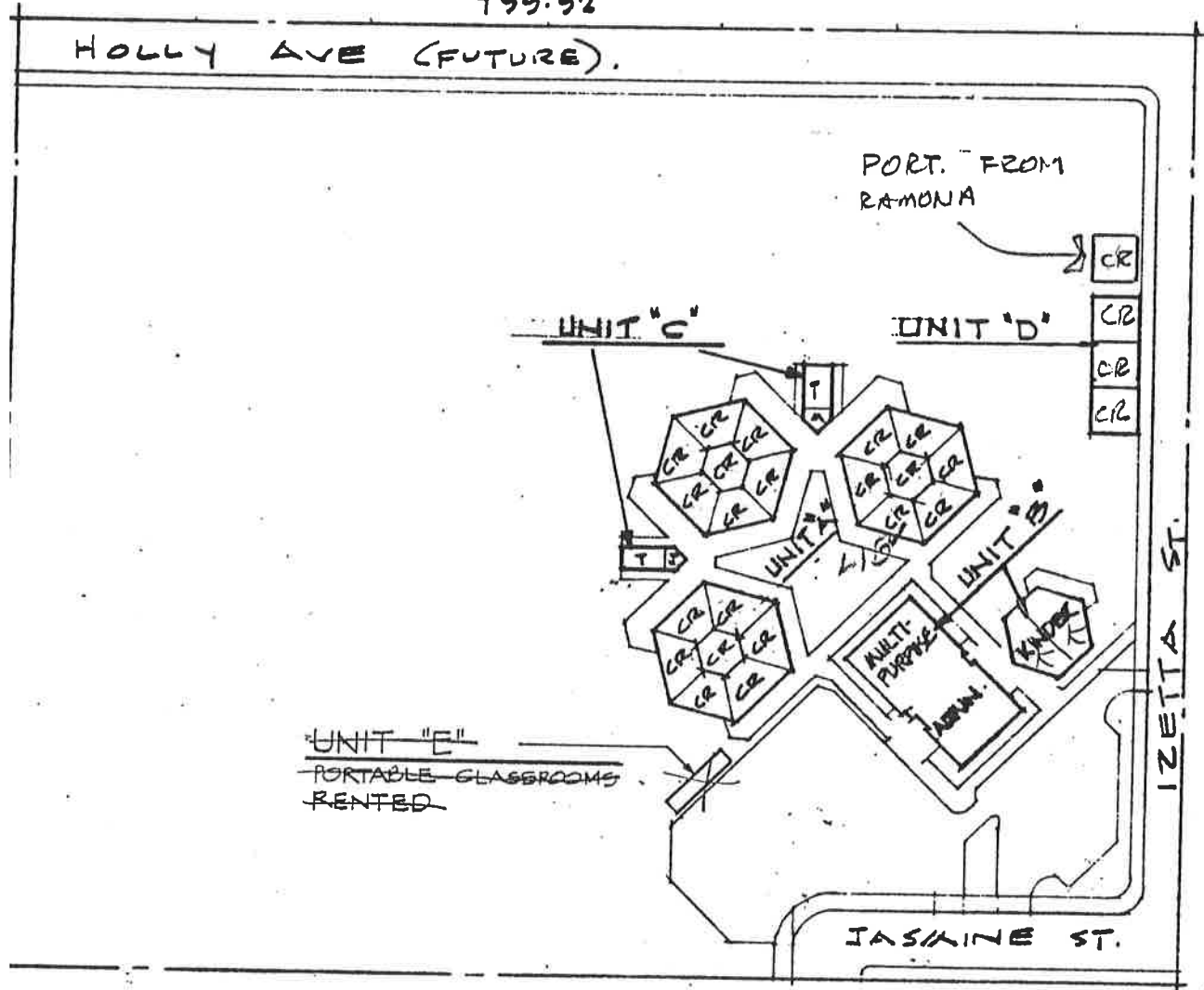

KEY PLAN. 1"=120'-0"

TOTAL BUILDING AREA

Unit "A"	23,865 Sq. Ft.	1966
Unit "B"	11,206	1967
Unit "C"	2,591	1966
Unit "D"	2,907	1968
Unit "E" NON CHARGEABLE		1981
<b>TOTAL</b>	<b>40,569 Sq. Ft.</b>	

REVISED 7/23/82

is measured in accordance with Article 2022  
 Chapter 8, Title 5, California Administrative Code

Date: 9 November 1967  
 Sheet . 1 of 5 Sheets  
 Office of School Planning  
 Department of Education

*[Signature]* Architect

ct: Sierra Linda Elementary School  
 Oxnard Elementary School District  
 ss: Izetta Street and Jasmine Street  
 Oxnard, California

Existing --- (1-A) ✓  
 Basic Plans (2-A)  
 Final Plans (3-A)

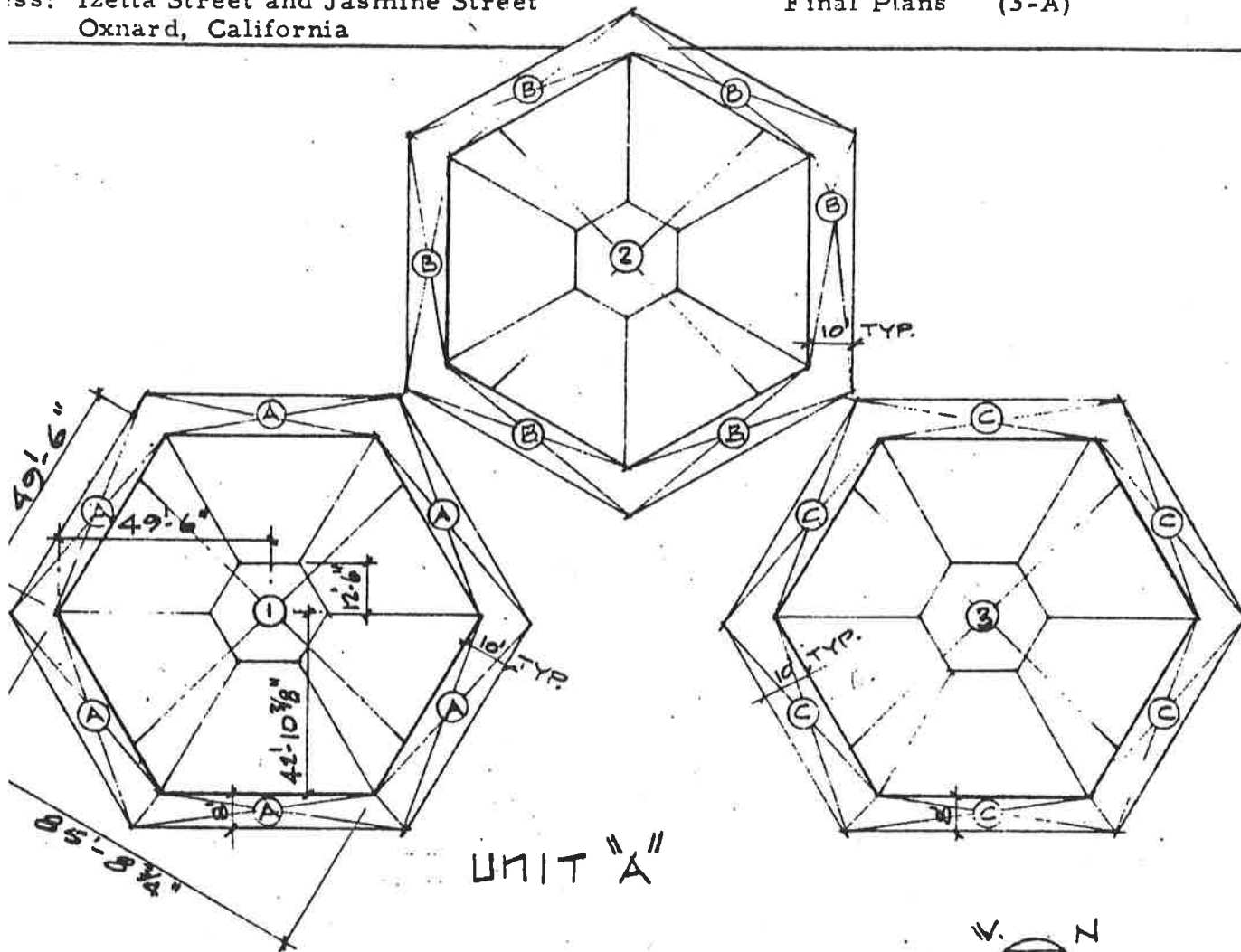

UNIT "A"

ALL DIMENSIONS.

AREA PLAN.  
1" = 40'-0"



PORTION	SIZE	AREA
Classrooms		
6 Rooms		969.6
1 Room		546.4
	6,364 x 3	19,092 Sq. Ft.
Shelter	3,182 + 2	1,591
Shelter	3,182 + 2	1,591
Shelter	3,182 + 2	1,591
TOTAL AREA UNIT "A"		23,865 Sq. Ft.

is measured in accordance with Article 2022  
 Chapter 8, Title 5, California Administrative Code

*[Signature]*

Architect

Date: 9 November 1967  
 Sheet 2 of 5: Sheets  
 Office of School Planning  
 Department of Education

Oxnard Elementary School District  
 Address: Izetta Street and Jasmine Street  
 Oxnard, California

Existing (1-A) ✓  
 Basic Plans (2-A)  
 Final Plans (3-A)

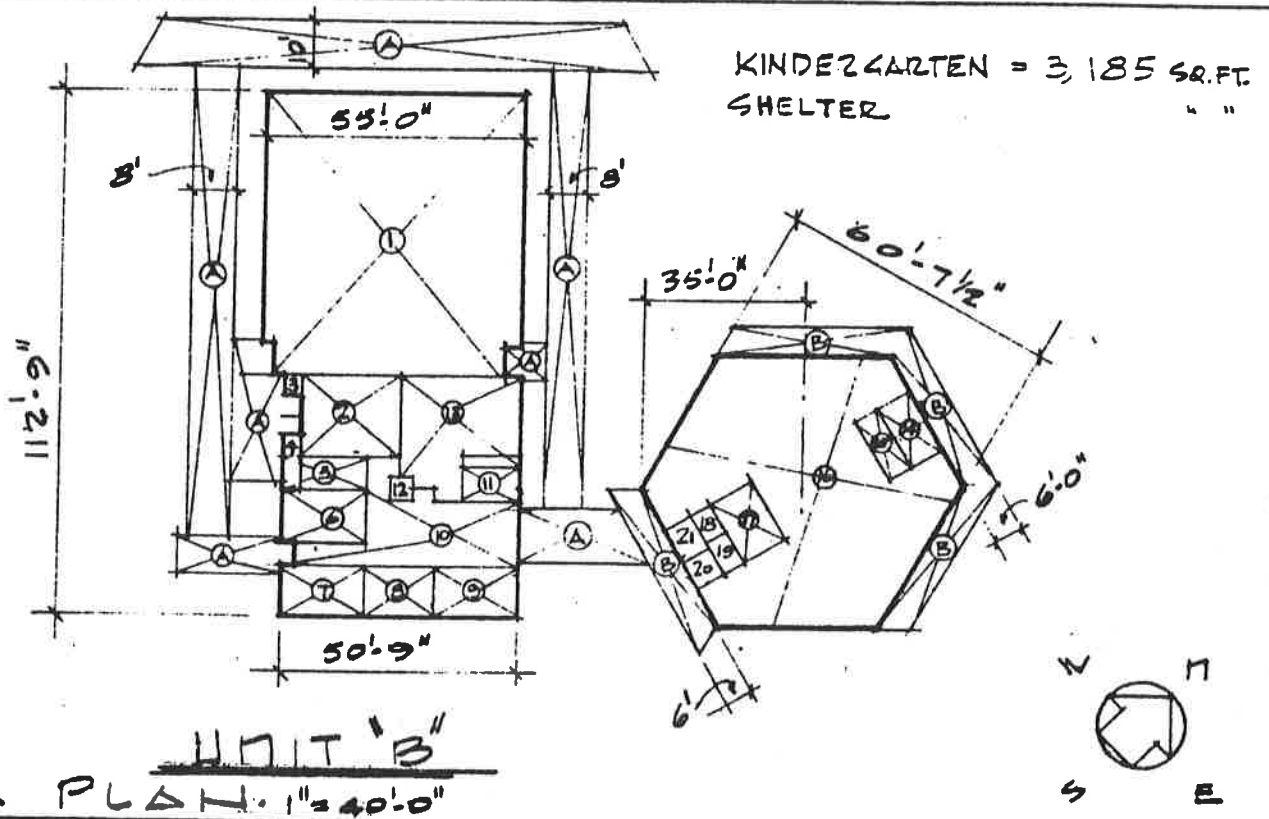

UNIT "B"  
 AREA PLAN. 1" = 40'-0"

PORTION	SIZE	AREA
Multi-Purpose Hall	55'0" x 61'6" - 6'-0" x 6'-6"	3,344 Sq. Ft.
Kitchen	16'3" x 18'0"	293
Electrical	4'7" x 4'9"	22
Mechanical	10'6" x 5'9"	60
Toilet	12'4" x 5'5"	67
Administration	18'0" x 12'6"	225
Storage	18'0" x 12'0"	216
Administration	15'0" x 12'0"	180
Administration	17'9" x 12'0"	213
Administration	32'9" x 14'0" + 24'-0" x 4'-6"	567
Toilets	12'8" x 5'0"	63
Storage	4'0" x 4'6"	18
Teachers	20'3" x 27'0" + 5'0" x 12'0"	607
Storage	17'8" x 6'8"	118
Toilets	17'8" x 5'0"	88
Classrooms	1330' x 2	2,660
Administration	11'0" x 15'0"	165
Toilet	3'6" x 7'0"	25
Storage	8'0" x 3'6"	28
Heater	6'8" x 6'9"	45
Janitor	8'4" x 6'9"	56
Shelter	3416 ÷ 2	1,708
Shelter	876 ÷ 2	438
TOTAL AREA UNIT "B"		11,206 Sq. Ft.

Area is measured in accordance with Article 2022 Chapter 8, Title 5, California Administrative Code

Date: 9 November 1967  
 Sheet 3 of 5 Sheets  
 Office of School Planning  
 Department of Education

*[Signature]* Architect

Oxnard Elementary School District  
 address: Izetta Street and Jasmine Street  
 Oxnard, California

Existing (1-A) ✓  
 Basic Plans (2-A)  
 Final Plans (3-A)

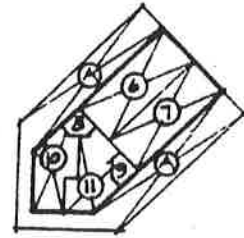
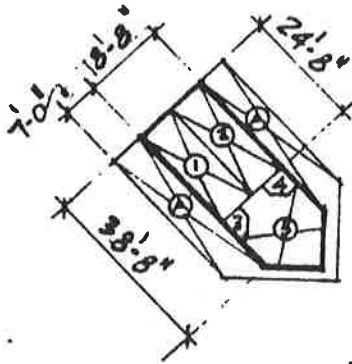

UNIT "C"

TYPICAL DIMENSIONS.

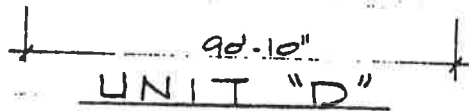
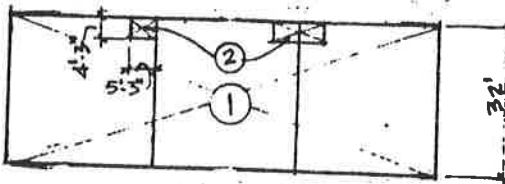

AREA PLAN.  
 1" = 40'-0"

PORTION	SIZE	AREA
Toilet	9' 11" x 24' 8"	244.7 Sq. Ft.
Toilet	8' 9" x 24' 8"	215.8
Toilet	5' 6" x 5' 0"	27.5
Toilet	5' 6" x 5' 0"	27.5
Janitor	17' 0" x 18' 8"	317.3
Toilet	8' 9" x 24' 8"	215.8
Toilet	9' 11" x 24' 8"	244.7
Toilet	5' 6" x 5' 0"	27.5
Toilet	5' 6" x 5' 0"	27.5
Janitor	20' 0" x 18' 6"	370.0
Mechanical	7' 9" x 16' 1"	124.6
Shelter	1,496 ÷ 2	748.0
<b>TOTAL AREA UNIT "C"</b>		<b>2,590.9 Sq. Ft.</b>
CLASSROOMS	(90'-10" x 32'-0") - 3 (5'-3" x 4'-3")	2,840 SQ. FT.
HEATER ROOMS	3 (5'-3" x 4'-3")	67
<b>TOTAL AREA UNIT "D"</b>		<b>2,907 SQ. FT.</b>

is measured in accordance with Article 2022  
 Chapter 8, Title 5, California Administrative Code

*Emmett H. ...* Architect

Date: 14 Oct. 1968  
 Sheet 4 of 5 sheets  
 Office of School Planning  
 Department of Education



# DIAGRAM OF BUILDING AREA

PROJECT SIERRA LINDA SCHOOL  
 DISTRICT OXNARD SCHOOL DISTRICT  
 LOCATION OXNARD, CALIFORNIA

EXISTING  
 PRELIM. PLANS  
 FINAL PLANS

1-A  
 2-A  
 3-A

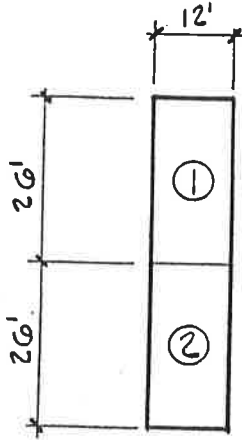

## AREA CALCULATIONS

①	CLASSROOM	12' x 26'	312 SQ.FT.
②	CLASSROOM	12' x 26'	312
TOTAL AREA UNIT "E"			624 SQ.FT.

NON CHARGEABLE

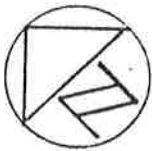

## UNIT "E" AREA PLAN

1" = 30'

MEASUREMENT IS MEASURED IN ACCORDANCE WITH SECTION 1810, STATE.

IN ACCORDANCE WITH EDUCATION BOARD REGULATIONS.

Senneth C. Kruger ARCHITECT

DATE: 1/23/52 SH. 5 OF 5 SHEETS  
 SCHOOL FACILITIES PLANNING  
 CALIF. DEPT. OF EDUCATION