

**OXNARD SCHOOL DISTRICT  
SURVEY OF SCHOOL SITES AND BUILDING SIZE**

DATE: 9-26-08

SCHOOL SITE: NUEVA VISTA  
ACREAGE: 0.45

| <b>BUILDING NO.</b> | <b>SQUARE FT.</b> | <b>CONST.DATE</b> | <b>PERMANENT</b> | <b>PORTABLE</b> | <b>REMARKS</b> |
|---------------------|-------------------|-------------------|------------------|-----------------|----------------|
| 1                   | 960               | 1989              |                  | X               | CLASSROOM      |
| 2                   | 960               | 1989              |                  | X               | CLASSROOM      |
| 3                   | 960               | 1989              |                  | X               | CLASSROOM      |
| 4                   | 960               | 1989              |                  | X               | CLASSROOM      |
|                     | <b>3840</b>       |                   |                  |                 |                |



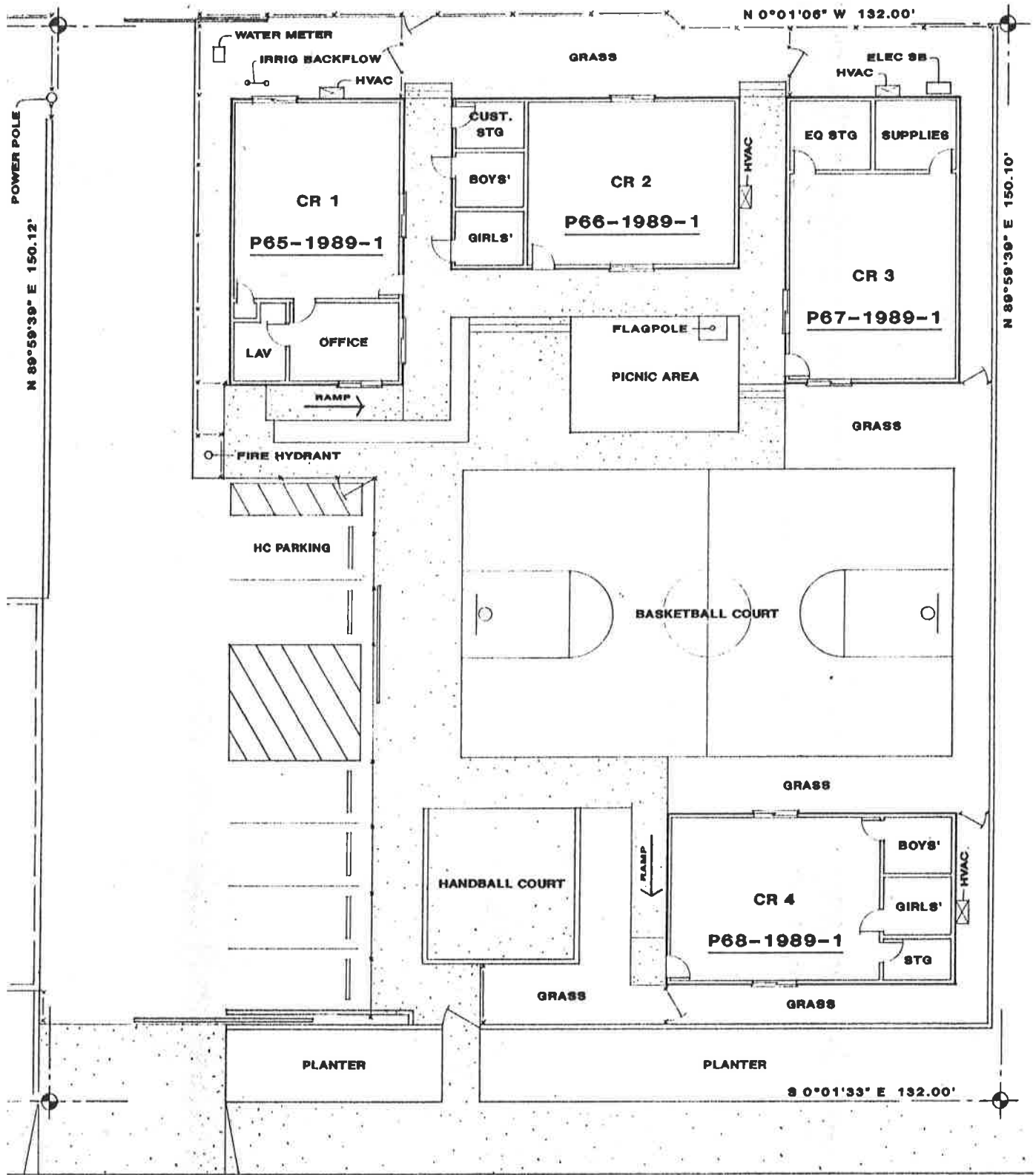

'A' STREET

BEAGE = 0.45 AC  
 LDING SQ. FOOTAGE = 3,840 SF  
 ISTRUCTION DATE = 1989

**SITE PLAN**  
 SCALE: 1" = 20'



21MAY93  
 AS SHOWN  
 JA

**OXNARD SCHOOL DISTRICT**  
**1051 SOUTH A STREET**  
**OXNARD, CALIFORNIA**

**PLAN**  
**NUEVA VISTA SCHOOL**

DRAWING No.  
**P 113**  
 SHEET 1 of 1