

**OXNARD SCHOOL DISTRICT
SURVEY OF SCHOOL SITES AND BUILDING SIZE**

DATE: 9-26-08

SCHOOL SITE: ESC
ACREAGE: 5.75
SQ. FT. OF BLDGS.:

| BUILDING NO. | SQUARE FT. | CONST.DATE | PERMANENT | PORTABLE | REMARKS |
|--------------|--------------|------------|-----------|----------|---|
| 1 | 35097 | 1976 | X | | ADMIN. OFFICES |
| 2 | 2719 | 1976 | X | | BOOK DEPOSITORY, OFFICES, OPEN STORAGE |
| 3 | N/A | 1976 | X | | OPEN STORAGE |
| 4(401) | 974 | 1974 | | X | TEACHERS TRAINING |
| 402 | 960 | | | X | BEST PRESCHOOL PROGRAM |
| 403 | 960 | | | X | PTC(MR.SHOOS OFFICE) |
| 5(501) | 960 | | | X | |
| 502 | 960 | | | X | |
| | 42630 | | | | |

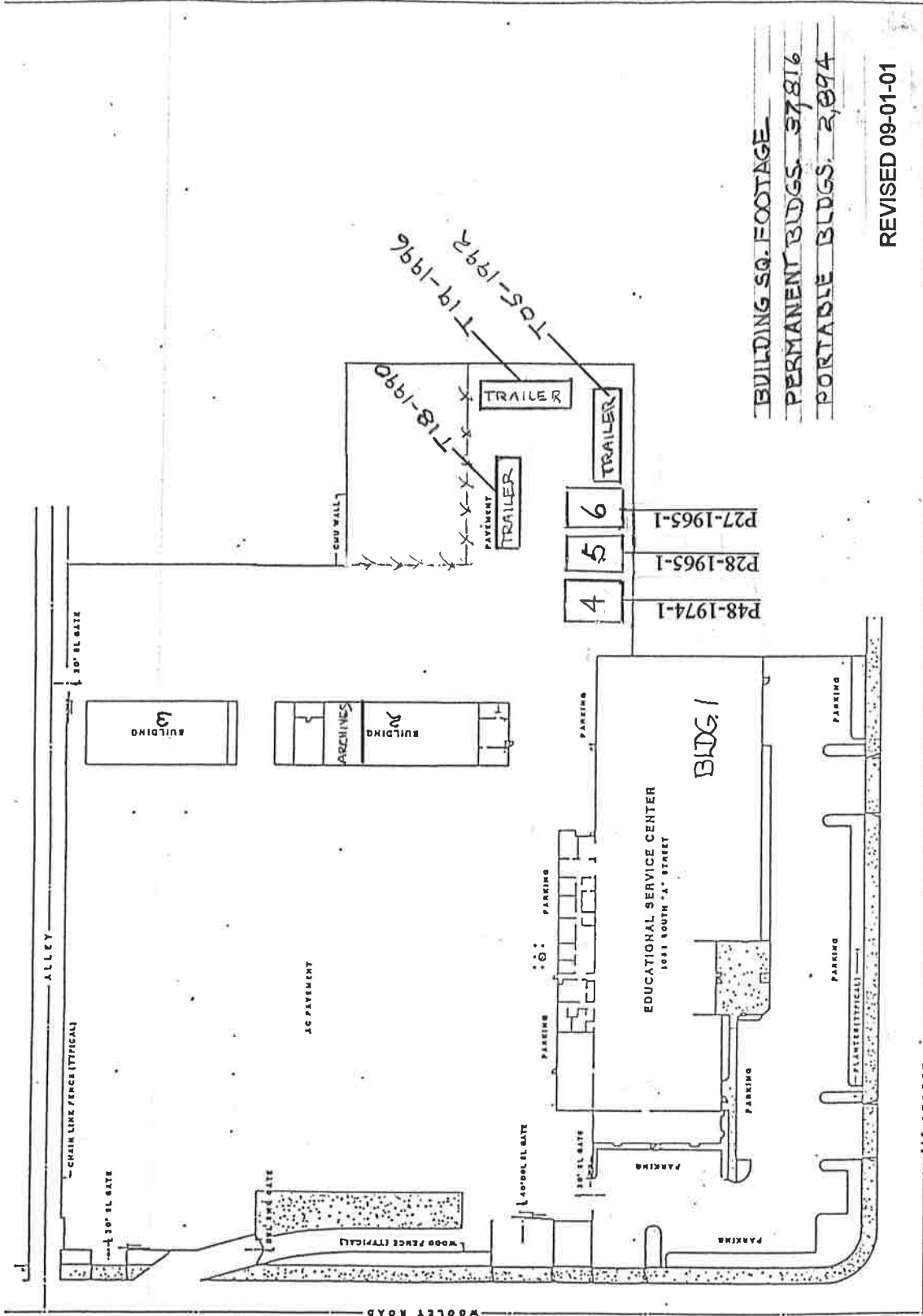

T-18-1996
T-19-1996
T-25-1992

BUILDING SQ. FOOTAGE
PERMANENT BLDGS. 37,816
PORTABLE BLDGS. 2,094

REVISED 09-01-01

| | |
|--|-------------|
| OXNARD SCHOOL DISTRICT OXNARD, CALIFORNIA | |
| DATE | APPROVED BY |
| DATE | APPROVED BY |
| DATE | APPROVED BY |

SITE PLAN
SCALE: 1" = 30'



REDUCED DRAWING
NOT TO SCALE

| | |
|---|------|
| SITE PLAN EDUCATIONAL SERVICE CENTER | |
| PROJECT NO. | DATE |

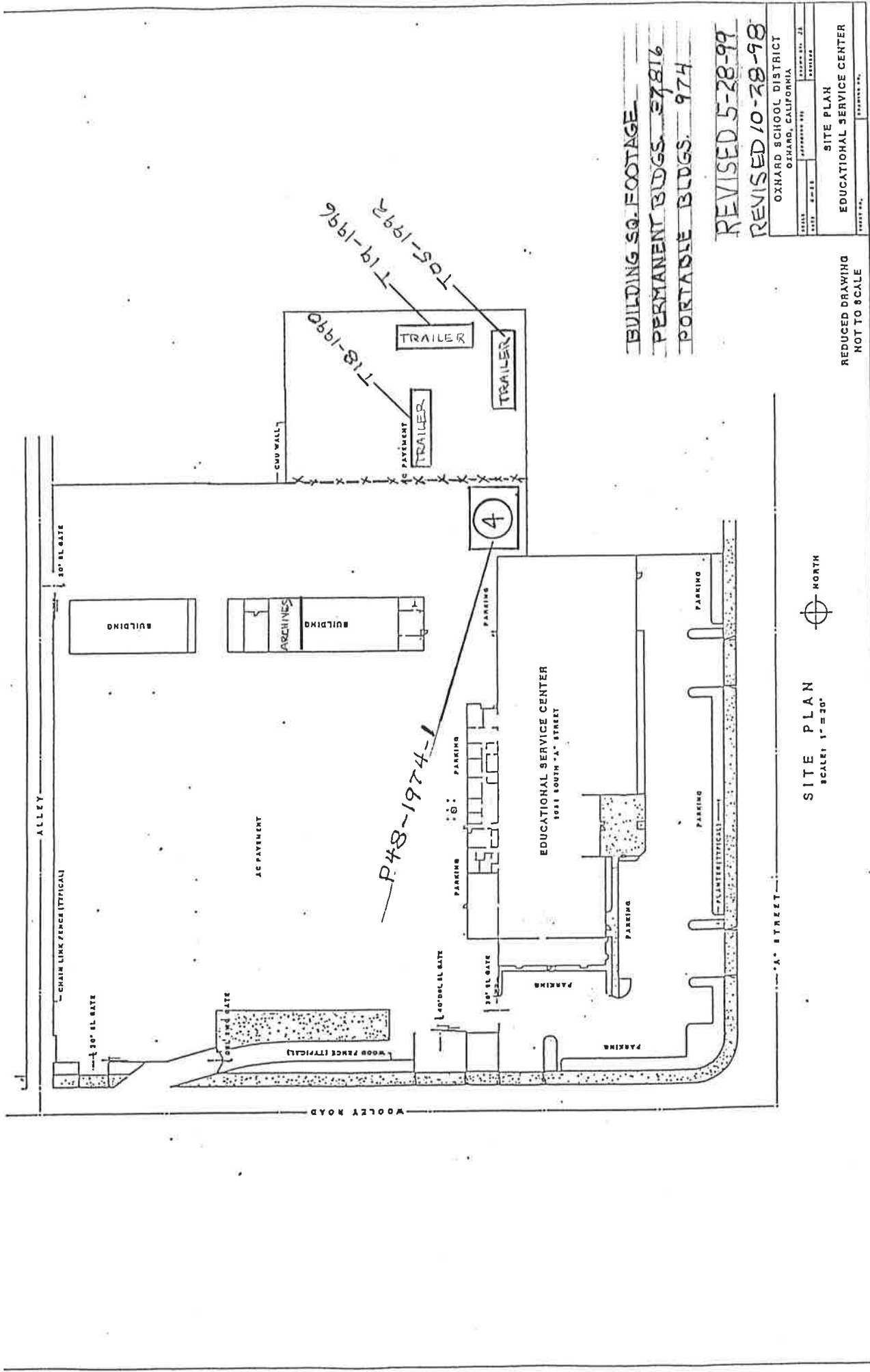

BUILDING SQ. FOOTAGE
 PERMANENT BLDGS. 27,816
 PORTABLE BLDGS. 974

REVISED 5-28-99
 REVISED 10-28-98

| | | | |
|--|--|----------------|-----------------|
| OXHARD SCHOOL DISTRICT OXHARD, CALIFORNIA | | DATE: 10/28/98 | BY: [Signature] |
| EDUCATIONAL SERVICE CENTER | | PROJECT NO.: | |

REDUCED DRAWING
 NOT TO SCALE

SITE PLAN
 SCALE: 1"=30'
 NORTH

P.48-1974-1

9661-1996
 2661-1991
 105-1991

4

30' SL GATE

CHAIN LINK FENCE (TYPICAL)

30' SL GATE

WOOD FENCE (TYPICAL)

AC PAYMENT

CONCRETE WALL

AC PAYMENT

TRAILER

PARKING

EDUCATIONAL SERVICE CENTER
 1021 SOUTH 'A' STREET

PARKING

PARKING

PARKING

PARKING

PARKING

PARKING

PARKING

PARKING

'A' STREET

ALLEY

WOOLLY ROAD

END:

- ELECTRICAL PANEL (MAIN) [RED]
- GAS SHUT-OFF VALVE (YELLOW)
- WATER HEATER [BLUE]
- IRRIGATION WATER SHUT-OFF VALVE [BLUE]
- DOMESTIC WATER SHUT-OFF VALVE [BLUE]

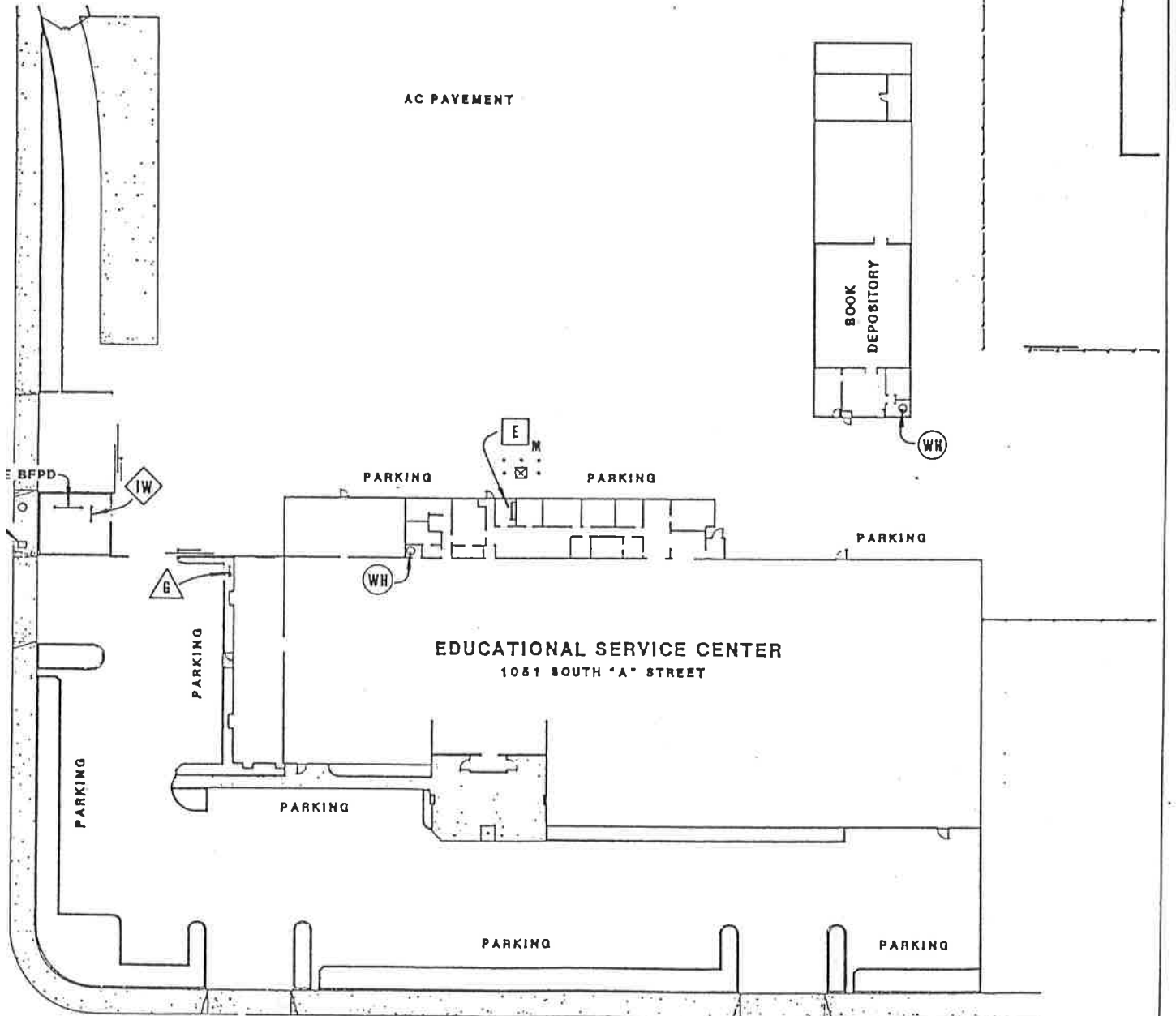

TRUCTION DATE = 1976
 IGE = 5.7 AC
 NG AREA = 37,816 SF

SITE PLAN



| | | | |
|------|------------------------|----------------------------|----------------------------|
| 1994 | OXNARD SCHOOL DISTRICT | PLAN | DRAWING No. |
| HOWN | 1051 SOUTH A STREET | EDUCATIONAL SERVICE CENTER | P 118 |
| JA | OXNARD, CALIFORNIA | | SHEET <u>1</u> of <u>1</u> |

